

Work Stand for Concrete Grinder

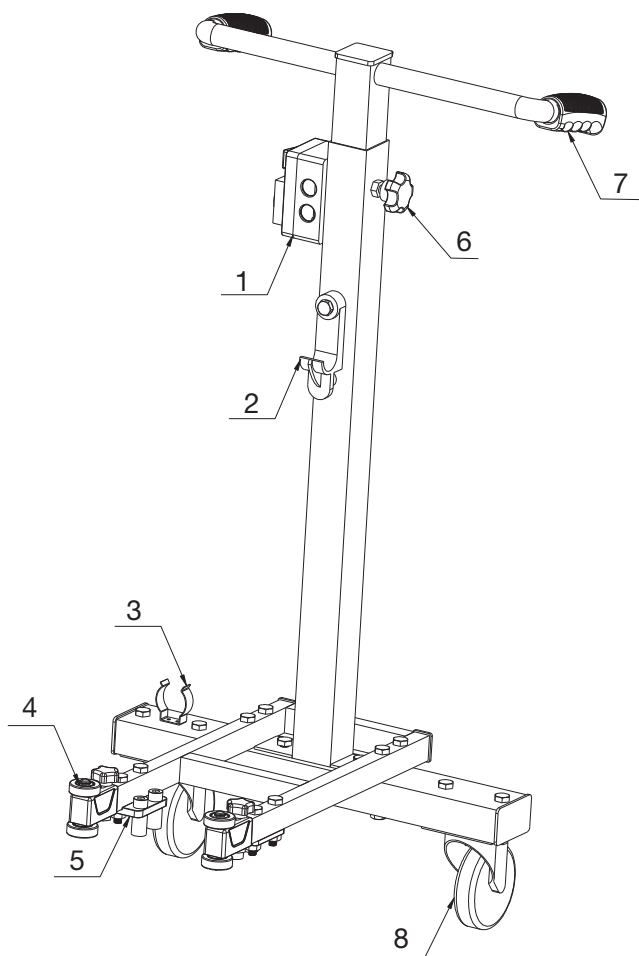



Spare Part List







1	Switch box	5	Junction plate
2	Shelf for hanging wire	6	Torx lock screw
3	Suction pipe buckle	7	Rubber handle
4	Bearing wheel	8	4" universal wheel

INDEX

- 1 Safety Warnings
- 2 Specification
- 3 Using Instructions
- 4 Cleaning and Maintenance
- 5 Environmental Protection
- 6 Warranty

Symbols

The following are the icons that are used for the tool. Make sure you fully understand them before using them.

	Read before use		Wear safety gloves
	CE mark		Wear hearing protectors
	Caution		Wear safety glasses
	Conforms to WEEE		

1. Safety Warnings

Please keep the workplace clean and bright;

Please keep the support frame away from the high temperature source, and flammable, explosive, corrosive liquids and gases;

Please protect the support frame from damage by external force or sharp objects, and pay attention to prevent falling damage;

Please do not work until the grinder and support frame are well connected;

Please don't keep the support frame exposed to rain and humidity for a long time;

This support frame is only used for CG1900 grinder. Please don't use for other brands.

Please keep eyes on abrasion of the universal wheel and bearing, and replace them in time;

Please put idle support frame outside the reach of children, and don't let someone unfamiliar with the support frame or who doesn't know the instructions operate the support frame.

Please send your support frame to professional maintenance personnel, and must use the same spare parts for replacement;

Please keep the handles clean, dry and oil-free.

2. Specification

Model	CGWS19
Material	A3 steel
Cord Length	2.5M
N.W.	8.6Kg
Max. working height	120cm
Min. working height	100cm

Manufacturer reserves the right to change specifications without notice.
Specifications may differ from country to country

3. Using Instructions

3.1 How to assemble a grinder and its support frame. For disassembly need, please do it in an opposite way.

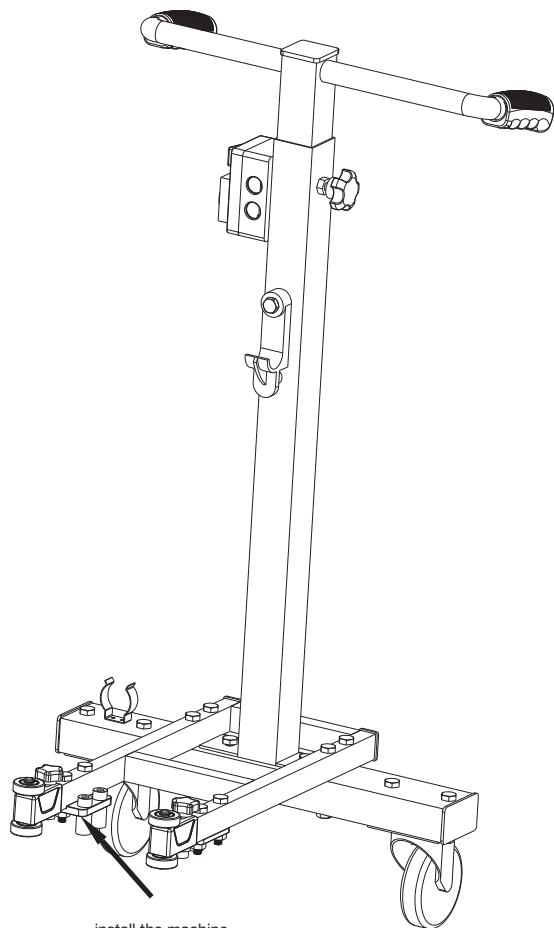

install the machine

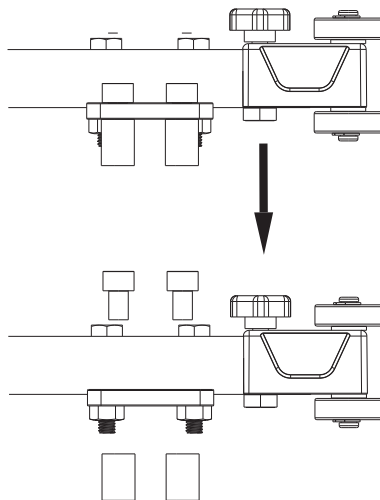

3.1.1 Split the thread bushing and screw

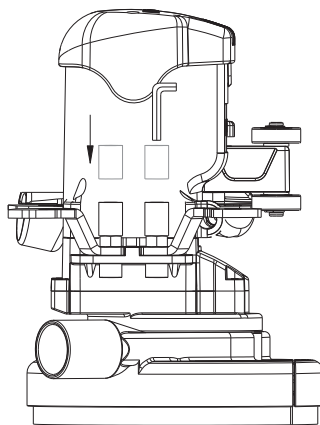

3.1.2: Use the Hex wrench to screw the thread bushing onto the exposed heads of four screws on your grinder

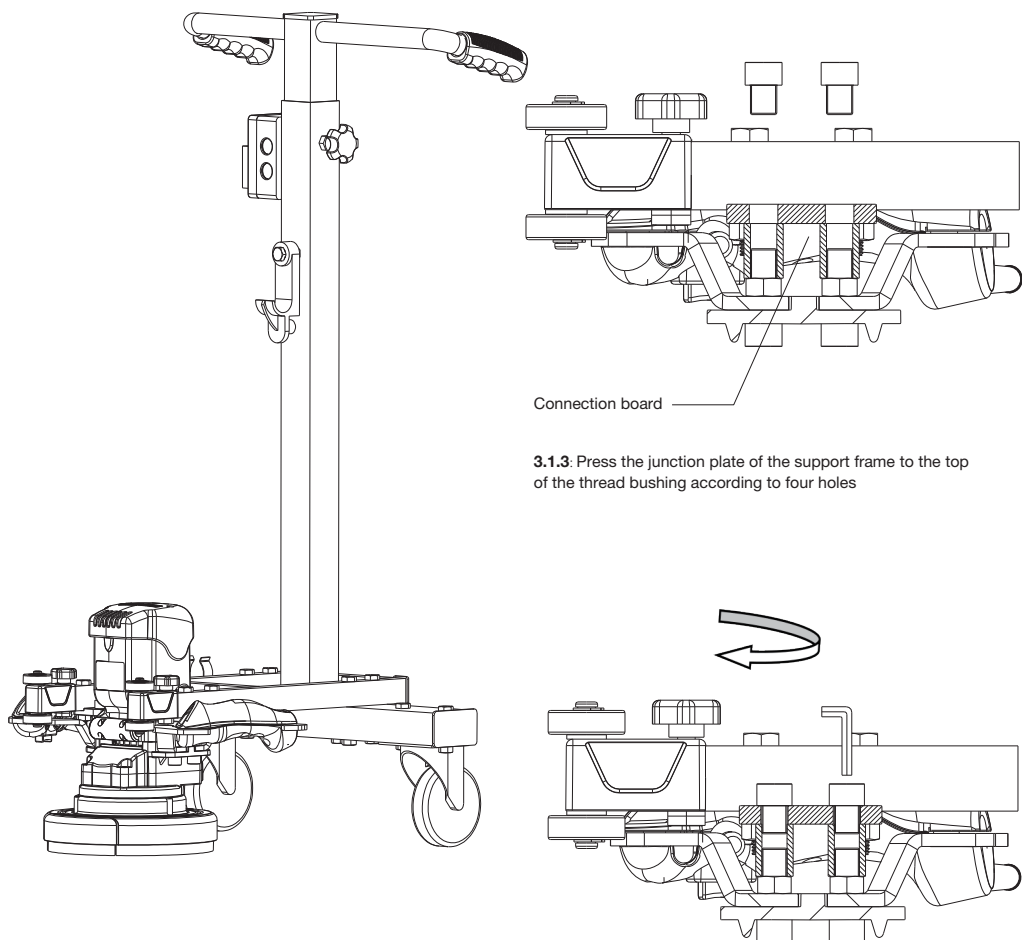

Connection board

3.1.3: Press the junction plate of the support frame to the top of the thread bushing according to four holes

3.1.4: Use a HEX wrench to turn the screws which you got from Step 1 into the thread bushing, please make sure the machine and the support frame have been well connected without any wobble.

3.2 How to adjust the height of the handle

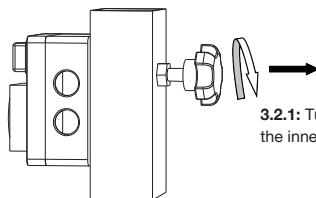
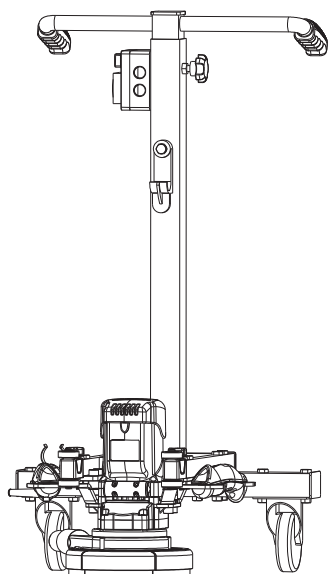

3.2.1: Turn the screw outward to loosen the inner tube, no need for completely out

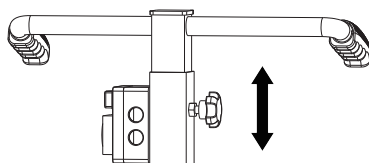

3.2.2: Adjust the handle up and down to a proper height

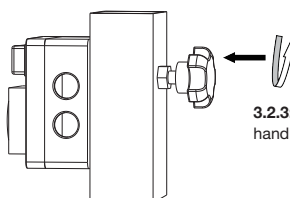

3.2.3: Turn the screw inward until the handle is fixed.

3.3 How to change the direction of the handle

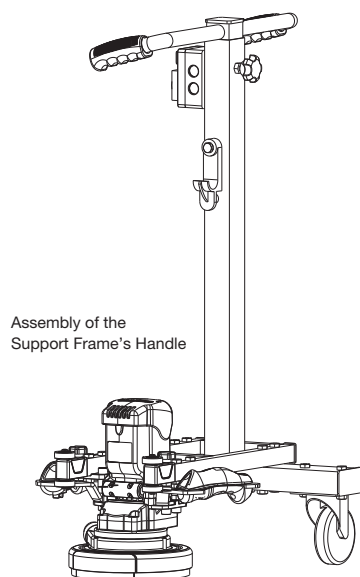

Assembly of the
Support Frame's Handle

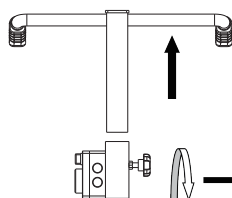

3.3.1: Turn the torx screw outward to loosen the inner tube, no need for completely out, and then take out the handle

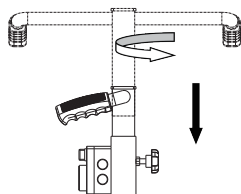

3.3.2: Rotate the handle by 90° and put it into the outer tube again.

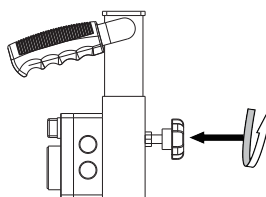

3.3.3: Adjust to a proper height and turn the torx screw inward until the handle is fixed

3.4 How to use a grinder for work with a support frame.

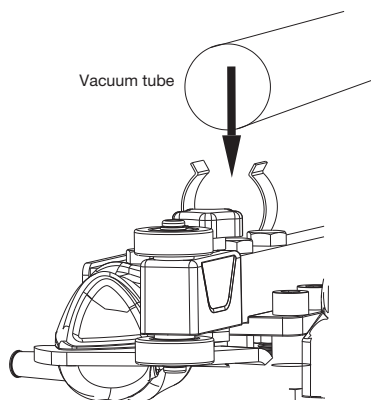
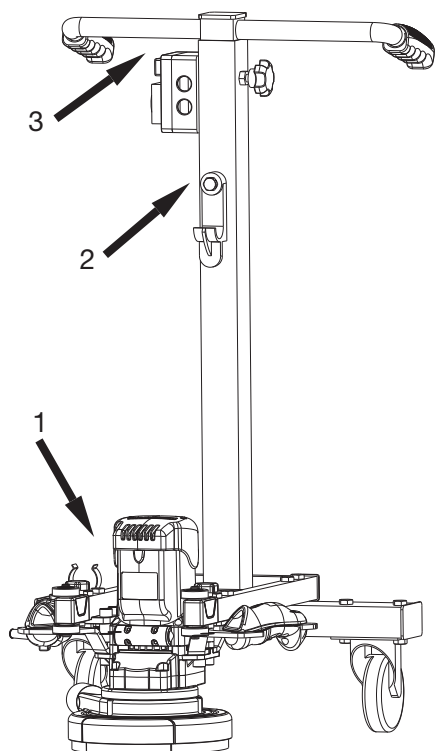

3.4.1: Connect the suction pipe to the buckle

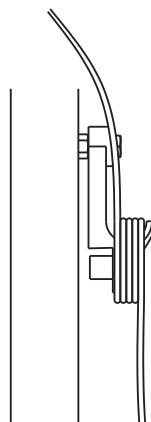

3.4.2: Neaten the grinder's wire and then hang it on the shelf of the support frame

3.4.3: Connect the grinder's plug to the outlet in a switch box, and then push button to "ON" (shown on Picture 3)

3.4.4: Start the grinder and grip two handles to drive the machine for working.

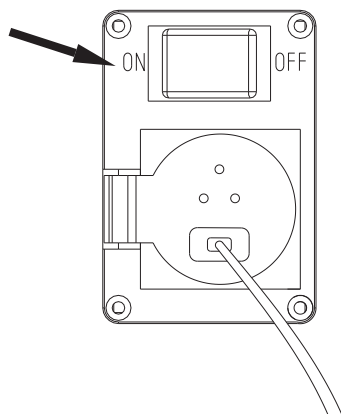

3.5 How a support frame supports the grinder with wall corner & edge working

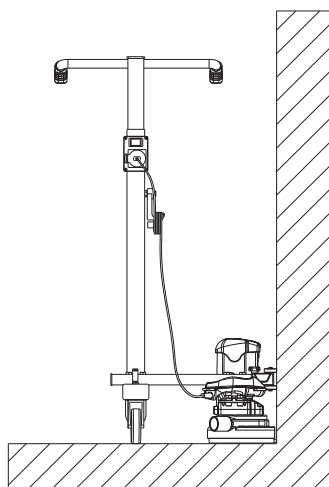

Wall Corner & Edge Working

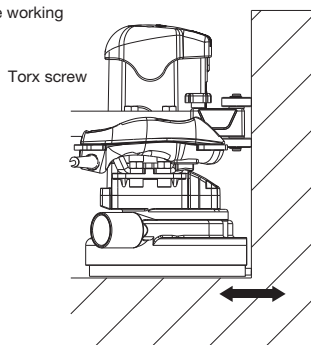

3.5.1: Loosen the torx screw and adjust the distance between the wheel and the wall, then tighten the screw again.

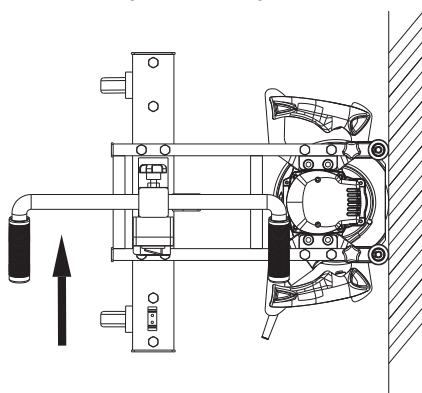

3.5.2: According to the direction shown, drive the machine stably for wall corner&edge working (please assure that the wheel gets close to the wall at the same time)

4. Cleaning and Maintenance

- **Maintain your grinder with care.** Clean the grinder immediately after use. Keep the grinder clean for best and safest performance. When maintaining this grinder, only the manufacturer's original replacement parts may be used.
- **Store idle equipment.** When not in use, the grinder should be stored in a dry location to prohibit rust.

5. Environmental Protection

- Do not dispose of electrical appliances in the household waste.
- Follow the local provisions for the disposal of electrical or battery products.
- Valuable materials can be recovered by recycling.
- The electrical or battery components used for construction are in accordance with the regulation European Directive 2012/19 / EU on waste electrical and electronic equipment and transposition into national law., used electrical appliances must be collected separately and recycled in an environmentally sound manner.
- Contact us for further information.



6. Warranty

- The guarantee covers all manufacturing or assembly defects in accordance with the legislation in force. The guarantee does not cover malfunctions caused by improper use, overloads, failure to follow the operating instructions and normal wear and tear.
- For more details and information, consult the general guarantee conditions at www.bihuitools.com